



## Affordable Reliable Service

Factory 11 no 17-23 Keppel Drive Hallam 3803, Victoria

Ph. +61 3 9799 1999

Fax. +61 3 8786 3005

[warehouse@aggdoors.com.au](mailto:warehouse@aggdoors.com.au)

### Coding MPC-1,2,3 Transmitters

1. In order to configure your B&D MPC Roller Door Opener you may need remove the Lower Panel Cover to access the buttons – See below for instructions.

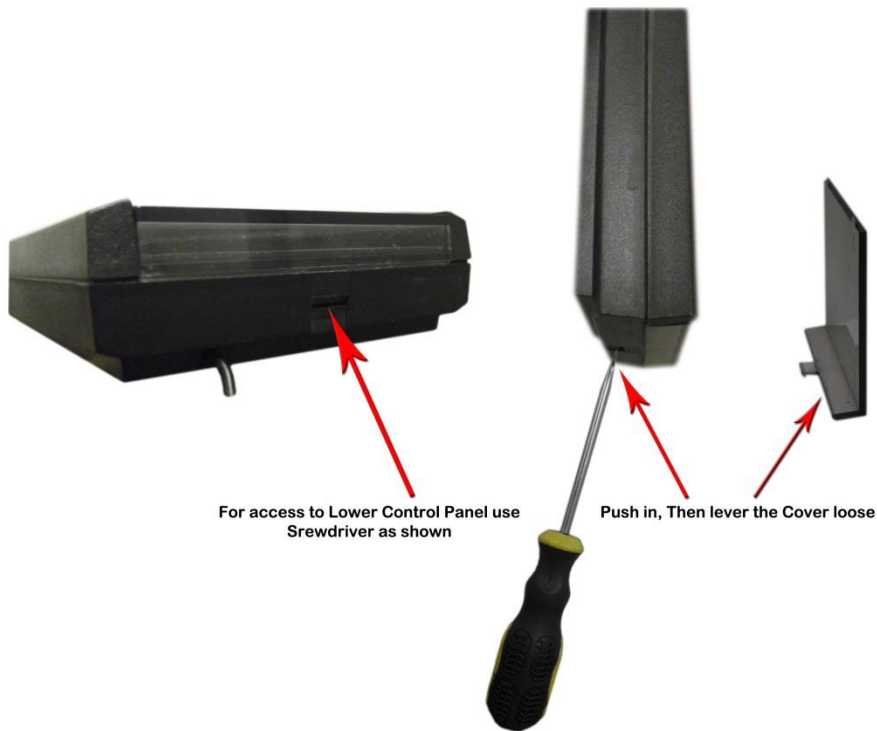

**MPC-1 LOWER CONTROL PANEL**

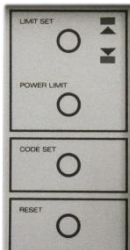

**MPC-1 (HD) LOWER CONTROL PANEL**



**MPC-2 LOWER CONTROL PANEL**



**MPC-3 (HD) LOWER CONTROL PANEL**

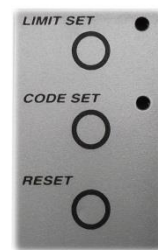

2. Setting your doors travel limits - This is usually required before you can code in the Transmitters – See below for instructions.

### MPC-1 & MPC-1 (Heavy Duty)

1. Make sure Power is turned on.
2. Remove lower cover like shown.
3. If 'LIMIT SET' lights are flashing, go direct to STEP 4. If not, push 'LIMIT SET'.
4. Press 'POWER LIMIT' and 'HOLD ON' until door stops at floor. Lower limit light will go out.
5. Press 'POWER LIMIT' and 'HOLD ON' until door reaches desired open position. (3cm below head stop is suggested)
6. If 'UPPER LIMIT' light is flashing, press 'LIMIT SET' to record open door position.

If 'UPPER LIMIT' light is NOT flashing, the position has been automatically recorded. DO NOT PRESS 'LIMIT SET'

*If limits are not correct, finish the sequence to STEP 6, then start again from STEP 3.*

7. Press 'UP STOP DOWN' and allow door to close fully.
8. Press 'LIMIT SET'.

**NOTE:** The automatic reversing will reach maximum sensitivity after 3 downward operations.



## MPC-2

1. Press 'LIMIT SET' to activate Limit Setting mode.
2. Press 'UP STOP DOWN' – The door will go DOWN and close hard on the floor. (If the door is already at the floor it will go UP then DOWN) The bottom limit will be accepted automatically & the Limit light will start flashing.
3. Press 'UP STOP DOWN' – Allow door to open fully and hit the top stops. The Limit light will go out and 'UP STOP DOWN' light will stop flashing.

*Both limits of door travel are now set. In normal operation the door stops just before hitting the floor or the top stops.*



## MPC-3 (Heavy Duty)

1. When powered up 'LIMIT SET' light should be on indicating that the unit is in limit set mode. If the light does not illuminate press 'LIMIT SET' once.
2. Press and hold 'UP STOP DOWN' to drive the door to the floor.
4. Press 'LIMIT SET' to accept lower limit. The 'LIMIT SET' light will now be flashing, indicating that the lower limit has been accepted and the unit is ready to set the upper limit.
5. Press and hold 'UP STOP DOWN' to drive the door up to the desired limit. (3cm below head stop is suggested)
6. Press 'LIMIT SET' to accept the upper limit. The 'LIMIT SET' light will extinguish, indicating both limits have been accepted.
7. Press 'UP STOP DOWN' to check the door operation.

*NOTE: The automatic reversing will reach maximum sensitivity after 3 downward operations.*

**3. Setting or changing the code for your Transmitters – See below for instructions.**

Lights 1-8

Hand Transmitter

Lights 1-8



Hand Transmitter

**MPC-1 & MPC-1 (Heavy Duty)**

1. Set Transmitter switch combination in any +, 0 or - position. (See below)
2. Press 'CODE SET'.
3. Press the hand Transmitter for 2 seconds. (Lights 1-8 will illuminate for 10 seconds to show that the code has been accepted)

### MPC-2

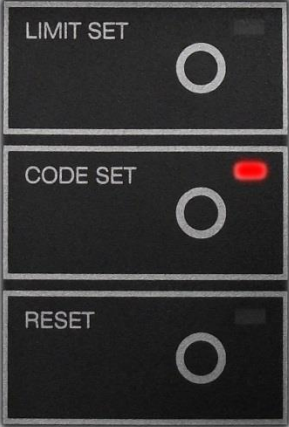
**Hand Transmitter**

1. Set Transmitter switch combination in any +, 0 or - position. (See below)
2. Press 'CODE SET'. (The 'CODE SET' light will come on)
3. Press the hand Transmitter for 2 seconds. (The 'CODE SET' light will go out and the 'UP STOP DOWN' light comes on when the code has been accepted)

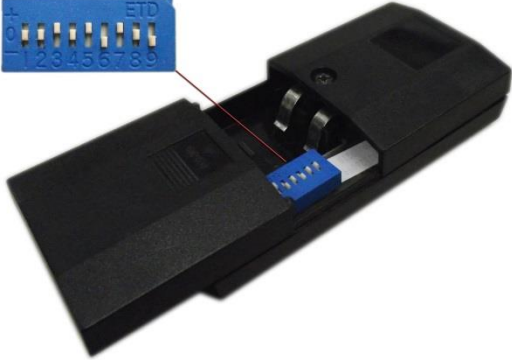

### MPC-3 (Heavy Duty)

**Hand Transmitter**





1. Set Transmitter slide switch to desired position - There are three positions Up, Middle & Down for coding more than one door. (See below)
2. Set Transmitter switch combination in any +, 0 or - position. (See below)
3. Press 'CODE SET'. (The light will come on)
4. Press hand transmitter for 2 seconds. (The 'CODE SET' light will go out to show the code has been accepted)



4. Purchasing compatible remotes (MPC-2 & MPC-3 ONLY) – See below for instructions.

Compatible Type 1



Compatible Type 2



➤ **METHOD 1** (Programmed from EXISTING remote(s) - These remotes are programmed using the same SWITCH combination of your existing remote(s).

*\*NOTE - For existing MPC-3 remotes the position of the SLIDE switch will also need to be programmed.*

➤ **METHOD 2** (Programmed with a RANDOM switch combination) – These remotes are programmed using a random SWITCH combination that can then be SET (coded in) using the previous procedure.

*\*NOTE – This option is for customers who have lost or no longer have existing remotes*

Below are samples of a small card that will accompany your randomly coded remote – You will need to keep these for future reference and purchases.

MPC2 CODE - Switch Position					
+	1		5		9
0	2	4	6	8	
-		3		7	

MPC3 CODE - Switch Position					
+		3		7	
0	2	4	6	8	
-	1		5		
Side Switch	UP				

5. For both EXISTING and COMPATIBLE remotes – Simply press the transmitter for at least half a second to operate.